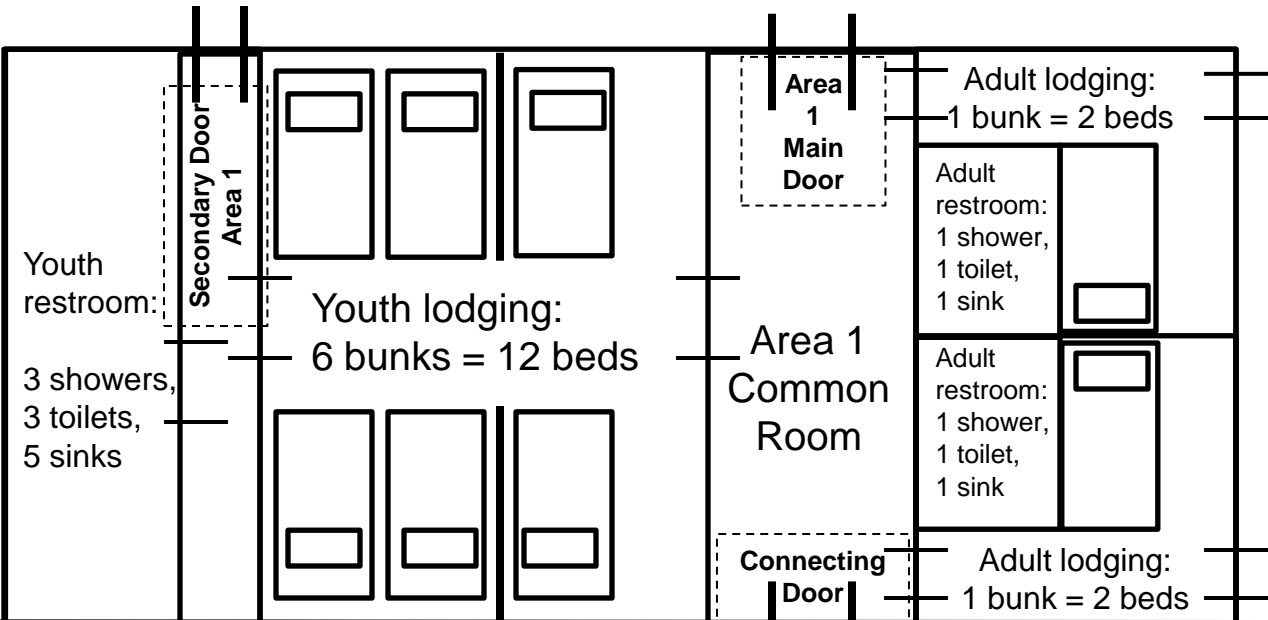

Image not drawn to scale

SAMPLE LAYOUT: 32-Bed Cabin = Two 16-Bed Areas

Area 1



Area 2

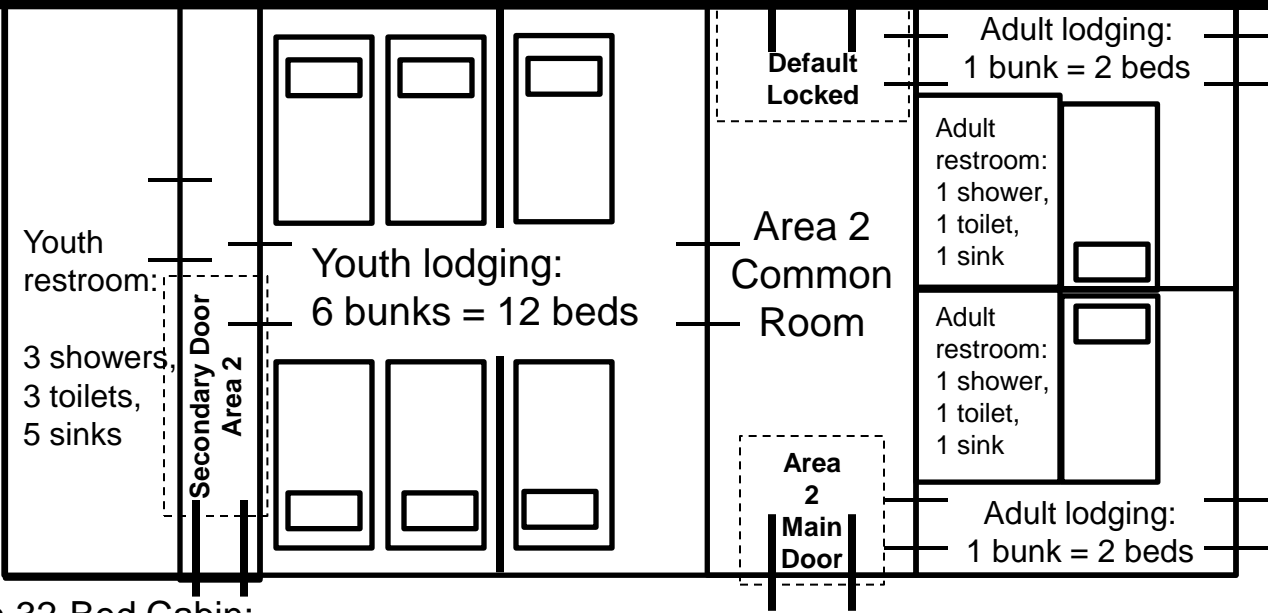

Summary of Lodging in 32-Bed Cabin:

Area 1 (16 total beds) = 4 adult beds and 12 youth beds; Area 2 (16 total beds) = 4 adult beds and 12 youth beds